



— WELCOME BACK TO —
SCHOOL

W.J. Carroll Intermediate School

2022-2023



School Map

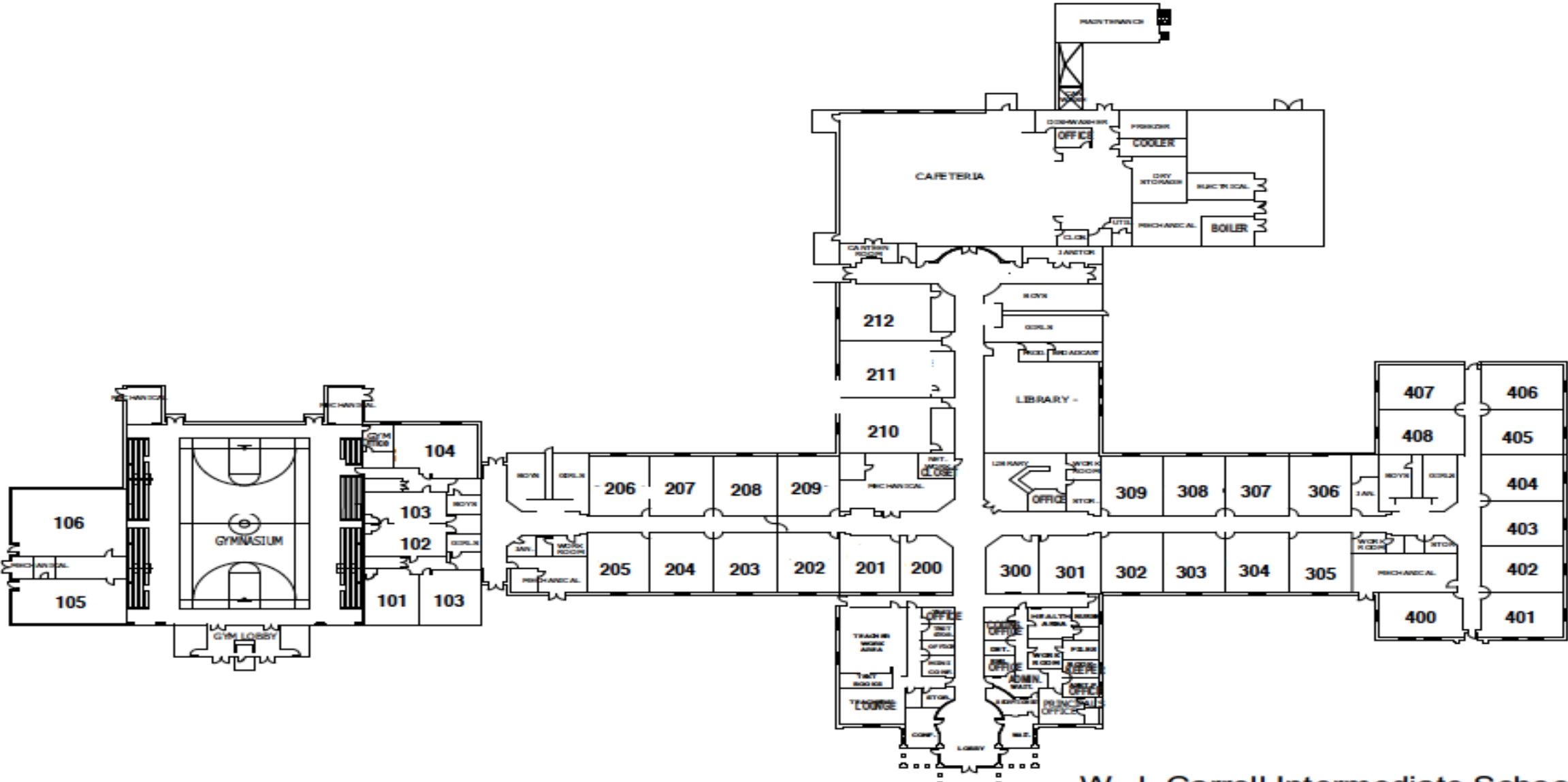

W. J. Carroll Intermediate School



- School begins at 7:50AM.
- Students are considered tardy if they arrive after 8:00AM. You MUST come to the FRONT DOORS to sign your child into school.

Early Check-out

- Please be sure to report to the front office before 2:30 pm to sign your child out for an early check-out.
- Changes in the afternoon dismissals should NOT be made by email.



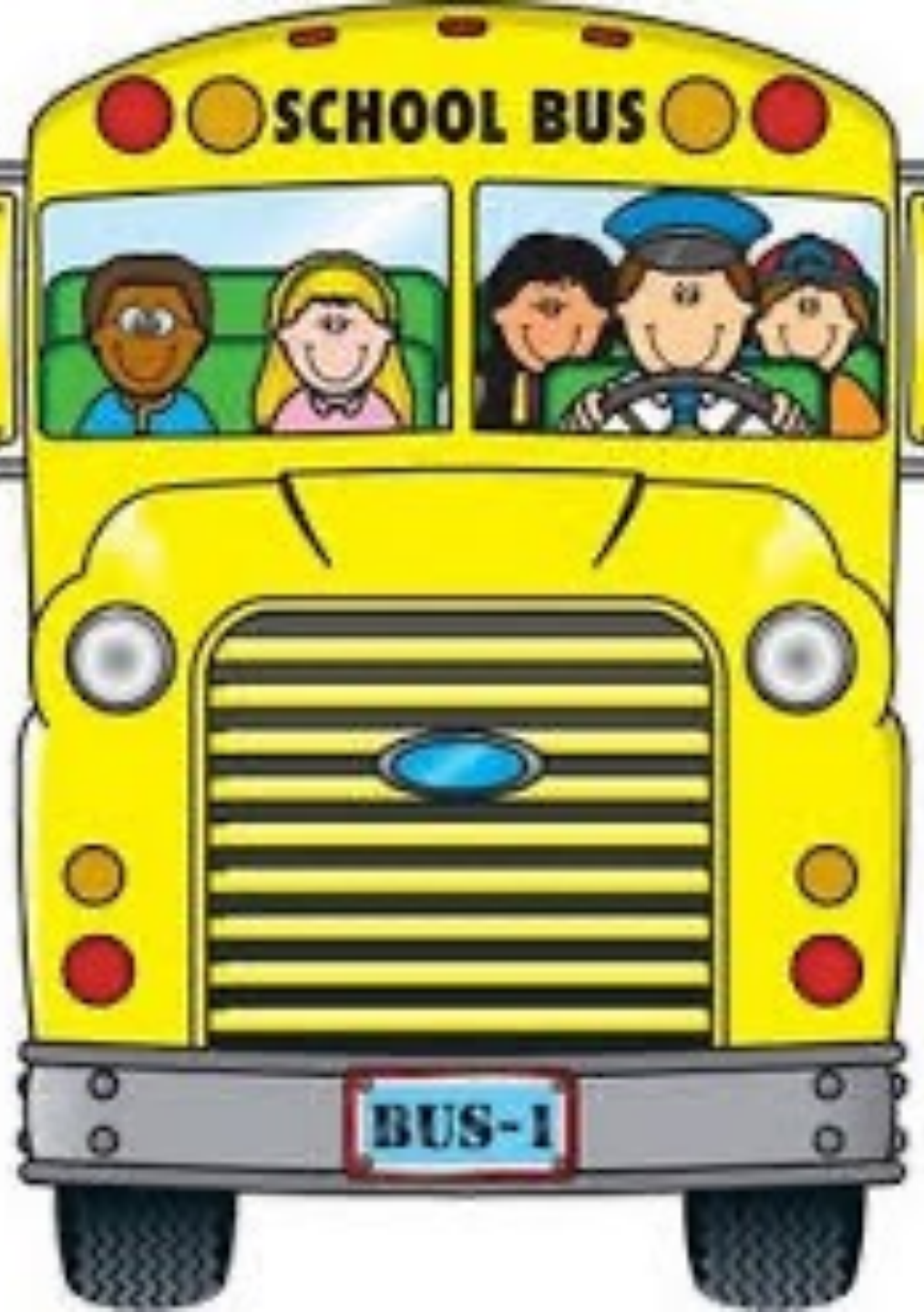

Dismissal

- First Dismissal bell rings at 2:55PM for car riders and one wave of buses.
- All students are dismissed by 3:10 PM each day.
- Please be sure to turn in your bus forms as soon as possible.



Bus Info

- Bus Routes have not changed since last year.
- Please call the office and ask to speak to Mrs. Riley regarding your bus concerns. You may also email her at cariley@bcbe.org

Carline

For the safety and security of all, please follow our traffic pattern and procedures.

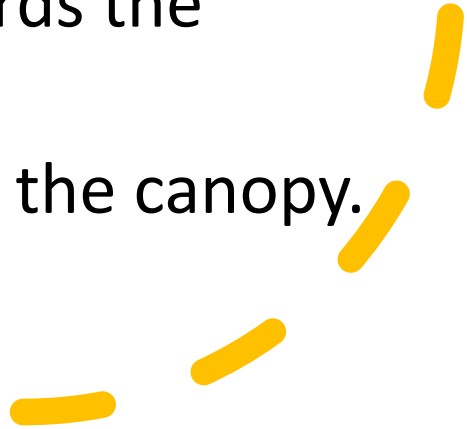
- Traffic Pattern
 - Enter on Thomas Avenue.
 - Immediately turn left onto our campus.
 - Begin forming two lines as you work your way to the back of the campus.
 - Do not block Thomas Avenue by starting two lines prior to entering our campus.
 - Then the lines will turn left towards the school building.
 - Finally arriving in two lines along the canopy.
- 

Carline Procedures

- We do not use numbers or call names. We expect students to look for their car.
 - As students arrive to carline, they may load their vehicle.
 - Lead teacher will blow the whistle twice. This signals that cars are about to start moving. At this time all students should be on the benches waiting for the next wave to load.
 - When the first wave exits and traffic is stopped, the lead teacher will blow the whistle once. This is the signal for students to load again. The first 8-10 cars located in front of the canopy load. Do not allow any others to load.
 - This procedure is repeated until carline is empty.
- 

Carline Map

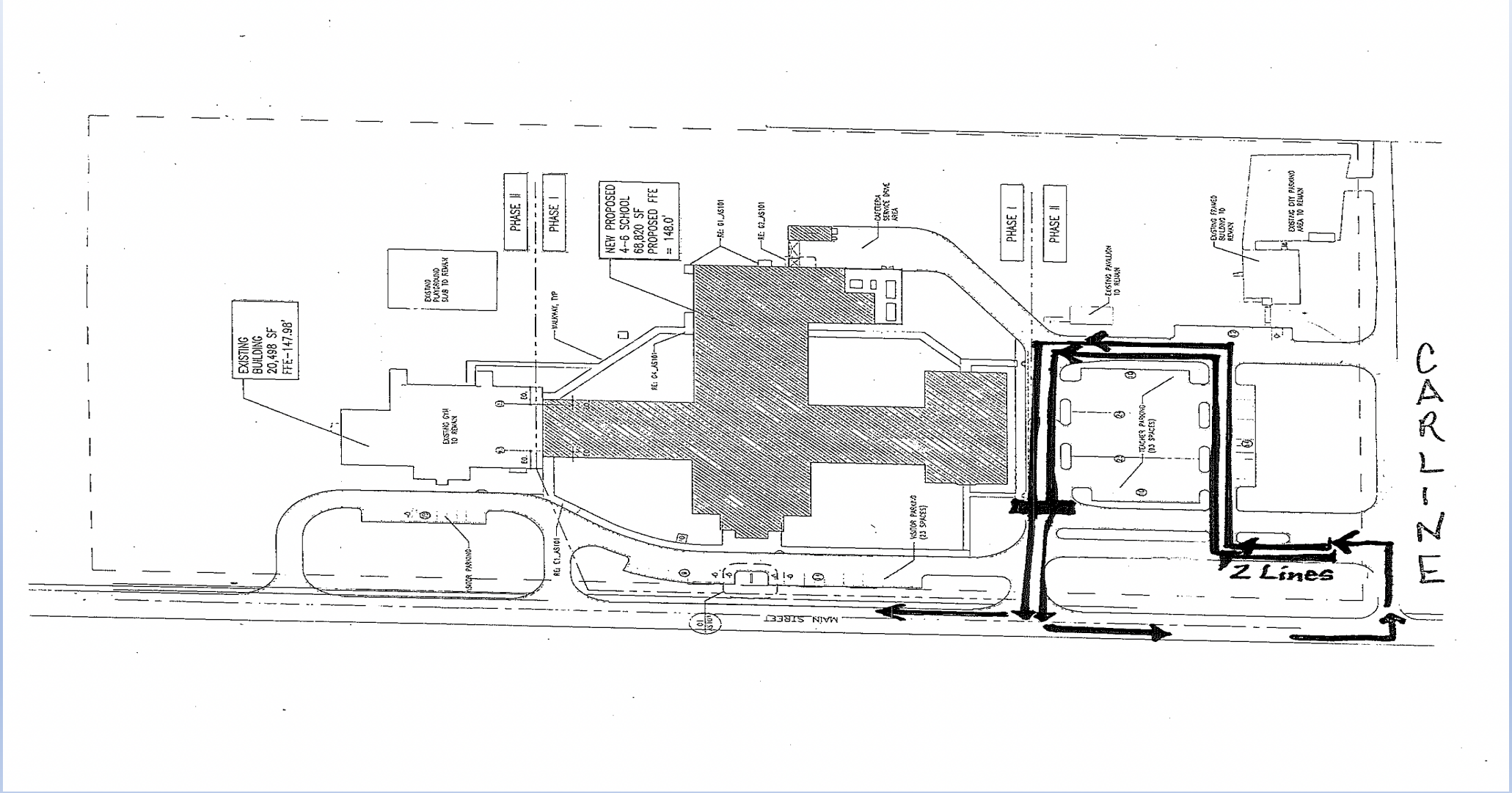

Spirit Shirts

Be sure to visit wjc.costaprints.com to order this year's shirts that can be worn any day of the week.

<h3>MAIN STREET SHIRT</h3>  <p>Products Are Custom Made To Order ALL SALES ARE FINAL</p> <p>Trojans 2022-2023 Port & Company DES_WJC_08 \$15.00</p>	<h3>LEADERSHIP SHIRT</h3>  <p>Products Are Custom Made To Order ALL SALES ARE FINAL</p> <p>Trojans Leadership 2022-2023 Port & Company DES_WJC_11 \$15.00</p>	<h3>TROJAN NATION SHIRT</h3>  <p>Products Are Custom Made To Order ALL SALES ARE FINAL</p> <p>Trojans 2022-2023 Port & Company DES_WJC_07 \$15.00</p>	<h3>LONG SLEEVE DRI-FIT SHIRT</h3>  <p>Products Are Custom Made To Order ALL SALES ARE FINAL</p> <p>100% Polyester DriFit Long Sleeve Sport-Tek DES_WJC_13 \$25.00</p>	<h3>CREWNECK SWEATSHIRT</h3>  <p>Products Are Custom Made To Order ALL SALES ARE FINAL</p> <p>DES/WJC Crewneck Sweatshirt Port & Company DES_WJC_14 \$25.00</p>	<h3>CREWNECK SWEATSHIRT</h3>  <p>Products Are Custom Made To Order ALL SALES ARE FINAL</p> <p>DES/WJC Crewneck Sweatshirt Port & Company DES_WJC_15 \$25.00</p>
<h3>DRI-FIT SHIRT</h3>  <p>Products Are Custom Made To Order ALL SALES ARE FINAL</p> <p>100% Polyester DriFit Short Sleeve Sport-Tek DES_WJC_12 \$20.00</p>	<h3>TIE-DYE SHIRT</h3>  <p>Products Are Custom Made To Order ALL SALES ARE FINAL</p> <p>Trojans Tie Dye 2022-2023 Port & Company DES_WJC_09 \$18.00</p>	<h3>NEON SHIRT</h3>  <p>Products Are Custom Made To Order ALL SALES ARE FINAL</p> <p>Trojans 2022-2023 Port & Company DES_WJC_10 \$15.00</p>	<h3>DAPHNE TROJANS FLEECE JACKET</h3>  <p>Products Are Custom Made To Order ALL SALES ARE FINAL</p> <p>Embroidered Port Authority Fleece Full Zip Jacket Port Authority DESWJC_Fleece \$35.00</p>	<h3>DAPHNE ELEMENTARY/ W.J. CARROLL CREWNECK SWEATSHIRT</h3>  <p>Products Are Custom Made To Order ALL SALES ARE FINAL</p> <p>DES/WJC Crewneck Sweatshirt Port & Company DESWJC_05 \$25.00</p>	<h3>DAPHNE ELEMENTARY/ W.J. CARROLL PULLOVER HOODED SWEATSHIRT</h3>  <p>Products Are Custom Made To Order ALL SALES ARE FINAL</p> <p>DES/WJC Hooded Sweatshirt Port & Company DES_WJC_06 \$30.00</p>

Baldwin County Public Schools Uniform Policy and Compliance Code

TOPS:

- White or Navy
- Collared shirt with sleeves or turtleneck.
- School color polo is dark purple.
- Small unobtrusive logo is permitted



Baldwin County Public Schools Uniform Policy and Compliance Code

BOTTOMS:

BOYS

- Khaki or Navy Blue Pants or Shorts, blue denim (corduroy fabric permitted)

GIRLS

- Khaki or Navy Blue Pants, Skirts, Capris, Shorts, Skorts, Jumpers or Dresses, blue denim (corduroy fabric permitted)
- Leggings may be worn with other bottoms but must be of uniform colors.



Baldwin County Public Schools Uniform Policy and Compliance Code



FOOTWEAR

- Closed Toe Footwear
- Footwear must be worn at all times and be closed toe in nature.

OUTERWEAR – Jackets, Sweatshirts, Coats and Sweaters:

- Must not have lettering; logo(s) of alcohol, tobacco, and/or controlled substance; nor pictures, symbols, or artwork offensive in nature and cause a disruption to the educational process. They are considered outerwear and must be worn with a uniform shirt.

Student Medications

Plan for this year

- Please contact our school nurse, Patty Vogel, at pvogel@bcbe.org if your child has medical concerns that require medication to be given at school or if you need to update any HealthCare plans.
- Parents may drop off students' medications during Meet the Teacher to the nurse station.
- After Meet Your Teacher, you must set up an **appointment** in order to drop off any medications for your child.



School Breakfast and Lunch

To ensure that we receive the proper federal funding for the 2022-23 school year, it is of utmost importance that everyone complete the free/reduced lunch application this year.

An application for free/reduced meals is available at

<https://www.myschoolapps.com/Application>



School Breakfast and Lunch

Child Nutrition Program Meal Prices
2022-2023

Breakfast

All Students Pre-K thru 12	\$ 2.00
Reduced Breakfast	\$ 0.30
Adult and Children Visitors	\$ 2.50
Second Breakfast Tray	\$ 3.00

Lunch

All Students Pre-K thru 12	\$ 3.00
Reduced Lunch	\$ 0.40
Adult and Children Visitors	\$ 4.25
Second Lunch Tray	\$ 4.00



A' la Carte Items

Please to go to www.myschoolbucks.com (link also on www.bcbe.org) to place funds in your child's account to purchase extra items.

This will speed up the flow of the line and decrease the exchange of cash and checks.

School Canteen

ALL ITEMS are \$0.50 or \$1.00

- Hot Cheetos
- Baked Chips
- Fruit Roll-ups (\$0.50)
- Cheez-Its (\$0.50)
- White Cheddar Popcorn
- Rice Krispy Treats
- Water

(as available)



Ice Cream Mondays, Wednesdays and Fridays

- Chocolate Sundae Crunch
- Strawberry Sundae Crunch
- Crumbled Cookie Cone
- Sour Blue Raspberry
- Cotton Candy Bar
- Sour Swell Bar
- Ice Cream Sandwiches

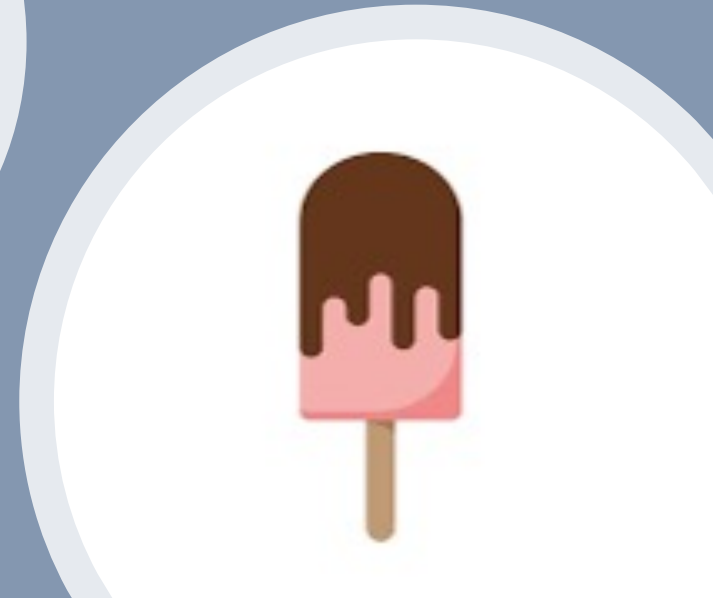

Healthy Snacks

- If you plan to send in a snack for your child to enjoy at **snack time**, be mindful of the BCBE Health and Wellness Policy and choose a healthy snack.



Birthday Snack

Birthday Snack

Let us help make life easier by providing these special snack options to help celebrate your child's birthday with classmates. These snacks meet the Baldwin County Board of Education Wellness Policy which can be located on our school website.

Birthday PACKAGE

Ice Cream: \$1.00 x # of students in class

ADDITIONAL ITEM:

"Happy Birthday" message will display on our WJC electronic sign on Main Street. The announcement will run the week of your child's birthday, so it's CRITICAL you purchase this package the week prior. The price for this add-on is an additional \$10.00 to the birthday package.



DEADLINES

Please pay close attention to ALL deadlines given on our campus. We hold true to these dates and times unless contacted prior to the deadline regarding emergency or extenuating circumstances.

NO Cell Phones

BCBE Policy 6.21

Cell phones and ALL Electronic Communication Devices are NOT permitted on school campus.

